

Floor Plans

MEETING SPACE

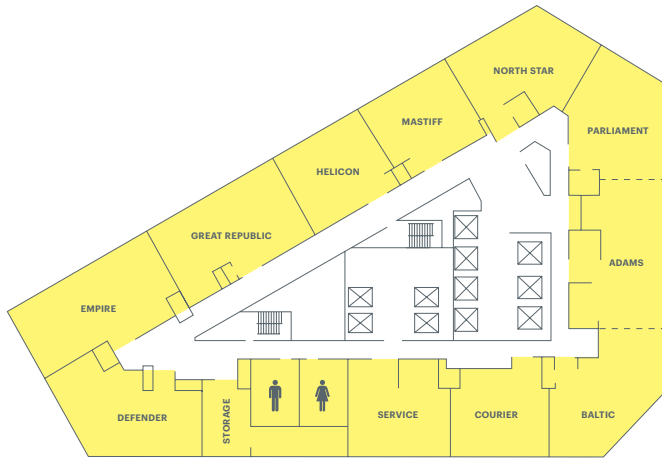

SEVENTH FLOOR

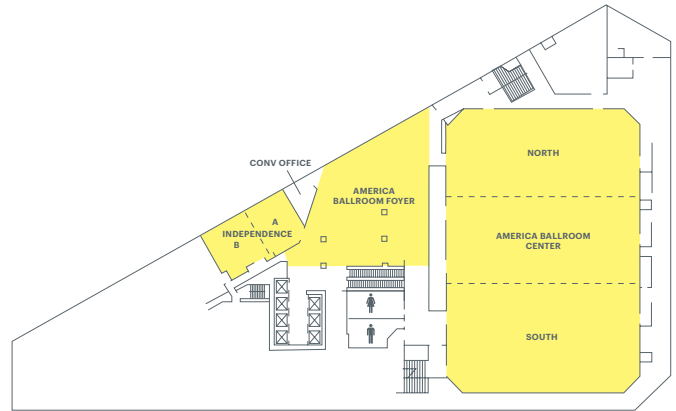

FOURTH FLOOR

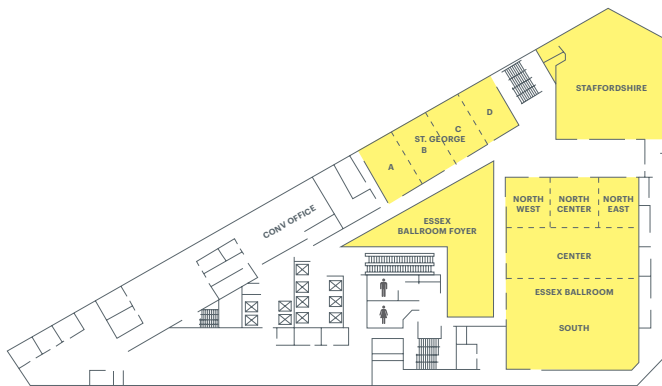

THIRD FLOOR

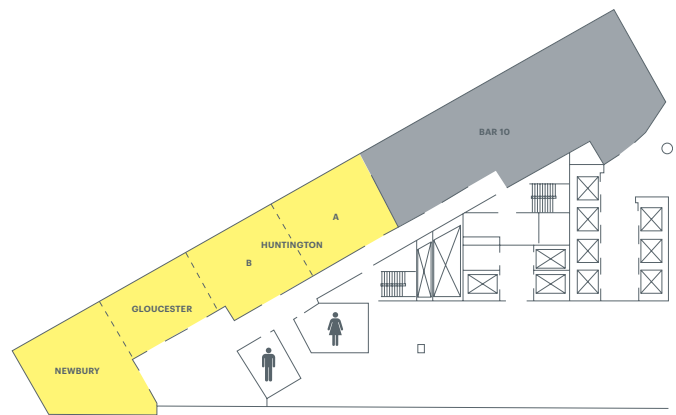

SECOND FLOOR

THE WESTIN
 COPLEY PLACE
 BOSTON

10 Huntington Avenue
 Boston, MA 02116
 USA

T +1 617.262.9600

westincopleyplaceboston.com

Capacity Charts

MEETING SPACE

ROOM NAME	TOTAL SQ. FEET	DIMENSIONS	CEILING HEIGHT	THEATER	CLASSROOM 3 PER 6	CONF.	U-SHAPE	HOLLOW SQUARE	RECEPTION	ROUNDS
SEVENTH FLOOR										
ADAMS/PARLIAMENT/BALTIC	2,640	79' X 24'	8'	120	60	50	50	50	175	180
ADAMS	960	43' X 24'	8'	64	42	34	33	26	64	40
BALTIC	827	33' X 34'	8'	40	20	14	14	16	55	40
COURIER	622	24' X 28'	8'	41	26	20	20	22	41	41
DEFENDER	888	30 X 45'	8'	59	41	28	24	28	59	59
EMPIRE	974	23' X 45'	8'	64	49	40	40	40	64	64
GREAT REPUBLIC	974	24' X 43'	8'	64	46	38	38	30	64	64
HELICON	646	24' X 28'	8'	43	26	16	22	26	43	43
MASTIFF	646	24' X 28'	8'	-	-	14	-	-	-	-
NORTH STAR	853	29' X 40'	8'	56	30	28	24	26	56	56
PARLIAMENT	853	30' X 40'	8'	56	30	28	24	26	56	20
FOURTH FLOOR										
AMERICA BALLROOM	15,337	152'2" X 101'10"	18'4"	1,800	970	-	-	-	2,000	1,200
AMERICA NORTH	4,685	46'6" X 101'10"	18'4"	450	250	96	70	80	500	360
AMERICA CENTER	4,701	46'2" X 101'10"	18'4"	450	250	96	70	80	500	320
AMERICA SOUTH	5,890	58'6" X 101'10"	18'4"	500	300	96	78	90	600	450
AMERICA BALLROOM FOYER	6,530	116' X 81'3"	11'	-	-	-	-	-	600	-
INDEPENDENCE A	700	-	10'	60	40	26	24	-	70	50
INDEPENDENCE B	608	-	10'	50	30	24	22	-	50	40
INDEPENDENCE AB	1,308	-	10'	90	70	32	30	-	120	80
THIRD FLOOR										
ESSEX BALLROOM	8,200	110'9" X 73'8"	15'	850	428	-	-	-	1,030	590
ESSEX CENTER	2,142	73'8" X 29'	15'	200	100	66	60	78	270	150
ESSEX SOUTH	3,912	73'8" X 52'10"	15'	380	200	66	60	78	490	310
ESSEX NORTH	2,142	73'8" X 29'	15'	200	100	66	60	78	270	170
ESSEX NORTH-SECTIONS	714	-	15'	50	40	26	18	24	80	50
ESSEX BALLROOM FOYER	5,746	106'3" X 107'10"	11' 2"	-	36	-	-	-	600	-
STAFFORDSHIRE	4,055	73'7" X 63'11"	13' 2"	270	165	66	62	78	400	260
ST. GEORGE	2,707	86'6" X 31'5"	11'	180	140	-	70	74	300	220
ST. GEORGE A	725	22'5" X 31'5"	11'	50	40	26	28	32	80	50
ST. GEORGE B	716	22'5" X 31'5"	11'	50	40	26	28	32	80	50
ST. GEORGE C	612	20'10" X 31'5"	11'	50	35	24	26	30	75	50
ST. GEORGE D	651	20'10" X 31'5"	11'	50	40	26	28	32	80	50
SECOND FLOOR										
GLOUCESTER	506	20' X 29'	12'	48	23	16	14	16	48	48
NEWBURY	768	28' X 35'	12'	48	36	20	24	24	48	48
GLOUCESTER/NEWBURY	1,274	35' X 57'	12'	90	50	40	40	40	112	112
HUNTINGTON	1,374	23' X 58'	12'	100	-	-	-	-	100	72
THE HUNTINGTON	2,574	23' X 115'	12'	-	-	-	-	-	250	180

THE WESTIN
COPLEY PLACE
BOSTON

10 Huntington Avenue
Boston, MA 02116
USA

T +1 617.262.9600

westincopleyplaceboston.com